

# 450S2

## PNEUMATIC STAPLER

### ENGRAPADORA NEUMÁTICA

### AGRAFEUSE PNEUMATIQUE

250-300 IN-LBS.  
TORQUE

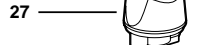
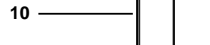
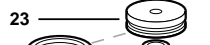
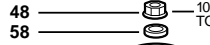
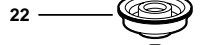
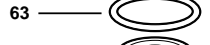
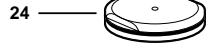

100-110 IN-LBS.  
TORQUE

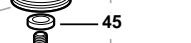

30-40  
IN-LBS.  
TORQUE



125-135 IN-LBS.  
TORQUE

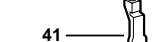
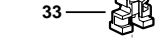
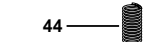
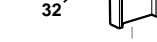
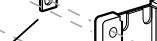

50-60 IN-LBS.  
TORQUE



30-40  
IN-LBS.  
TORQUE

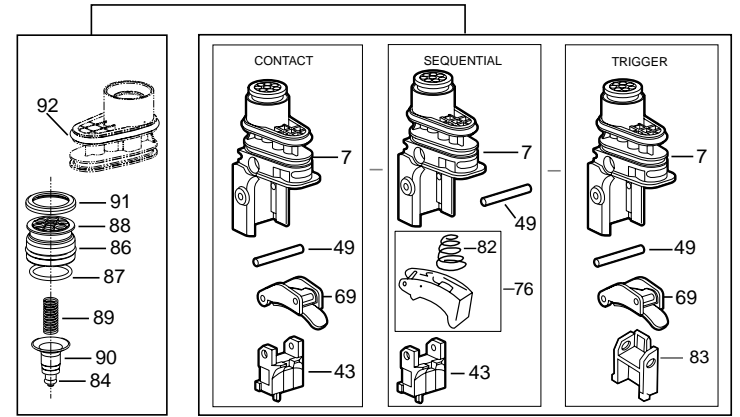

30-40 IN-LBS.  
TORQUE



SEE REVERSE SIDE FOR ACCESSORIES  
(NOT INCLUDED)

## Spare Parts for 450S2

Item#	Illus. #	Description
100258	1	SCREW,SHCS,M4X0.7X35
100279	2	O-RING,1.612X.103
101525	3	VALVE,ENERGY CONTROL
102044	4	PIN,SPIROL 3MMX16MM
102166	5	LABEL,MAGAZINE CAPACITY
102168	6	SCREW,SPECIAL (MAGAZINE)
TVA9	7	KIT,STANDARD MODULE
103208	8	TUBE,EXHAUST
103211	9	SEAL,CHECK
103214	10	DRIVER,(1IN)
103217	11	BRACKET,MAGAZINE
103218	12	BUSHING,TOGGLE PIN
103222	13	PUSHER (1IN)
103447	14	TOGGLE,MAGAZINE
103549	15	SPRING,COVER
103558	16	LATCH,MAGAZINE
103601	17	SLEEVE,BRACKET
103770	18	SPRING,COMPRESSION
103791	19	HANDLE,PUSHER
103795	20	DISC,LATCH STOP
103858	21	PIN,SPRING,4X20MM
103993	22	BUMPER,TOP L/P
103994	23	PISTON
103995	24	CAP,SLEEVE L/P
103996	25	RING,PISTON L/P
103997	26	SLEEVE,CYLINDER-L/P
103998	27	BUMPER,LOWER L/P (1")
103999	28	BULKHEAD,SLEEVE - L/P
104027	29	COVER,TRIP L/P

104064	30	PROTECTOR,FRONT FRAME L/P
104067	31	BUSHING,MAGAZINE COVER
104068	32	NOSE ASSEMBLY (1IN)
104339	33	ADJUSTER,TRIP
104623	34	ARM,UPPER CONTACT
104931	35	CASTING,NOSE COVER
104974	36	WEARPLATE (1IN)
104975	37	PLATE,NOSE
105057	38	GASKET,END CAP L/P
105070	39	EXHAUST DEFLECTOR
105073	40	COVER,MAGAZINE
105163	41	ARM,CONTACT
105797	42	LABEL
105932	43	ARM GUIDE ASSEMBLY
105934	44	SPRING,COMPRESSION
105959	45	WASHER,PISTON
106051	46	SPRING,EXTENSION
MHE5080-100	47	NUT,NLN M5X.8
MHE6100-100	48	NUT,ESN M6X1
106058	49	PIN,SPRING,M3X32
106059	50	PIN,ROLL,M4X30MM
106097	51	LABEL,PATENT
106147	52	LABEL,WARNING C/T
106172	53	ASSEMBLY,MAGAZINE,2IN
121168	54	FRAME/GRIP
106292	55	CAP,END L/P
106334	56	PIN,SPIRAL 4X10MM
106474	57	TOP GUIDE
106691	58	WASHER,SPECIAL M6
106871	59	PIN,SPRING 4X32MM
107071	60	TIP,CORE (2")

107129	61	O-RING,.268X.075
850607	62	O-RING,1.484X.139
850628	63	O-RING,1.734X.139
851554	64	O-RING,.703X.103
MLW5	65	WASHER,HSLW M5
MPG030012	66	PIN, ROLL 3 X 12
MSC5080-20	67	SCREW,SOC HD. CAP M5 X 20
MSC6100-35	68	SCREW,SHCS,M6X1.00X35
N50082A	69	ASSEMBLY,TRIGGER
T50078	70	ANCHOR, PUSHER SPRING
T60024	71	PIN,SPECIAL(MAG NUT)
SEQ2	76	KIT,SEQ TRIP CONV.
110009	81	LABEL,POWER VALVE
100387	82	SPRING, COMPRESSION
106173	83	STOP,TRIGGER
105996	84	O-RING,.087 X .059
102164	86	O-RING,.728 X .059
102163	87	O-RING,.591 X .059
101541	88	HEAD VALVE
101540	89	SPRING,COMPRESSION
101533	90	SEAL,EXHAUST
101532	91	SEAL,HEAD VALVE
102197	92	O-RING,1.174 X .103
108212	93	ASSY,400/500 SERIES S2 LM
106427	94	WRENCH,SLEEVE CAP
112604	95	CAP,WEIGHT-L/P