

**ACCESSORIES AVAILABLE**  
**ACCESORIOS DISPONIBLES**  
**ACCESSOIRES DISPONIBLES**

BC601	4 oz. Bostitch Air -Tool Lubricant
BC602	1 pint Bostitch Air -Tool Lubricant
BC603	1 pint Bostitch "Winter-Formula" Air-Tool Lubricant
BC604	1 quart Bostitch Air -Tool Lubricant
851385	Loctite Grade 242 (.02 oz.)
115262	Softfoot

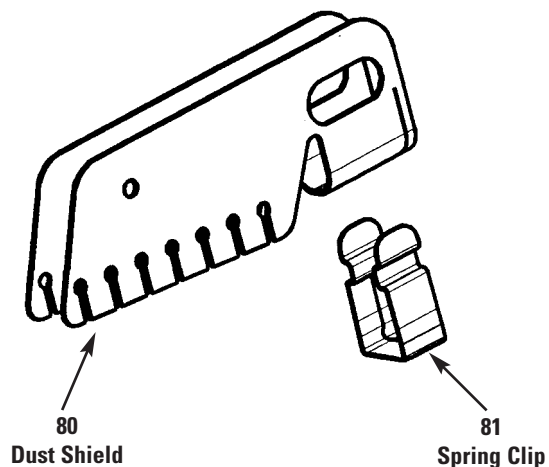

# BOSTITCH®

## N88RH-2MCN

**PNEUMATIC STICK NAILER**  
**CLAVADORA NEUMÁTICA ALIMENTADA POR BARRA**  
**CLOUEUR PNEUMATIQUE EN BANDES**



**TOOL PARTS ILLUSTRATION**  
**ILUSTRACIÓN DE LAS PIEZAS DE LA HERRAMIENTA**  
**ILLUSTRATION DES PIÈCES D'OUTILLAGE**

**⚠ WARNING:**

**⚠ ADVERTENCIA:**

**⚠ ATTENTION:**

BEFORE PERFORMING REPAIRS ON THIS TOOL, ALL OPERATORS SHOULD STUDY THIS ILLUSTRATION, AS WELL AS THE PARTS LIST AND OPERATION AND MAINTENANCE MANUAL. OPERATORS SHOULD UNDERSTAND AND FOLLOW ALL SAFETY WARNINGS AND INSTRUCTIONS. KEEP THIS ILLUSTRATION WITH THE TOOL FOR FUTURE REFERENCE. IF YOU HAVE ANY QUESTIONS, CONTACT YOUR BOSTITCH REPRESENTATIVE DISTRIBUTOR.

ANTES DE LLEVAR A CABO CUALQUIER REPARACIÓN EN LA HERRAMIENTA, TODOS LOS OPERARIOS DEBERÁN ESTUDIAR ESTA ILUSTRACIÓN, ASÍ COMO LA LISTA DE PIEZAS Y EL MANUAL DE OPERACIÓN Y MANTENIMIENTO. LOS OPERARIOS DEBERÁN ENTENDER Y SEGUIR TODAS LAS ADVERTENCIAS E INSTRUCCIONES DE SEGURIDAD. CONSERVE ESTA ILUSTRACIÓN CON LA HERRAMIENTA PARA PODER CONSULTARLA EN LO FUTURO. SI TUVIERA ALGUNA PREGUNTA, PONGÁSE EN CONTACTO CON SU REPRESENTANTE O DISTRIBUIDOR DE BOSTITCH.

AVANT DE PROCÉDER À LA RÉPARATION DE CET OUTIL, LES OPÉRATEURS DOIVENT ÉTUDIER LA PRÉSENTE ILLUSTRATION AINSI QUE LA LISTE DE PIÈCES ET LE MANUEL D'INSTRUCTIONS ET D'ENTRETIEN ; ILS DOIVENT ÉGALEMENT COMPRENDRE ET OBSERVER LES CONSIGNES DE SÉCURITÉ ET LES INSTRUCTIONS. CONSERVER CETTE ILLUSTRATION AVEC L'OUTIL POUR RÉFÉRENCE FUTURE. SI VOUS AVEZ DES QUESTIONS, COMMUNIQUEZ AVEC VOTRE REPRÉSENTANT OU VOTRE DISTRIBUTEUR DE BOSTITCH.

IP1155-1REVB 11/03

**BOSTITCH®**  
STANLEY FASTENING SYSTEMS

# N88RH-2MCN

**PNEUMATIC STICK NAILER**  
**CLAVADORA NEUMÁTICA ALIMENTADA POR BARRA**  
**CLOUEUR PNEUMATIQUE EN BANDES**

125-140 IN LBS.  
OF TORQUE  
(144-161 CM-KG)

125-140 IN LBS.  
OF TORQUE  
(144-161 CM-KG)

60-70 IN LBS.  
OF TORQUE  
(69-81 CM-KG)

30-45 IN LBS.  
OF TORQUE  
(35-52 CM-KG)

30-45 IN LBS.  
OF TORQUE  
(32-52 CM-KG)

12-15 IN LBS.  
OF TORQUE  
(14-17 CM-KG)

60-70 IN LBS.  
OF TORQUE  
(69 - 81 CM KG)

300-330 IN LBS.  
OF TORQUE  
(346-380 CM-KG)

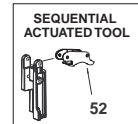

\*When replacing 158457 spring, grease  
spring body prior to installation.

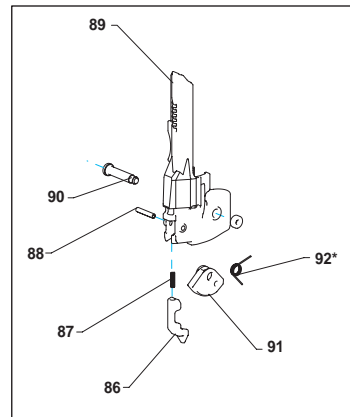

Item#	Illus. #	Description
MSF8125-25	<u>1</u>	SCREW, SFHCS M8 X 1.25X25
108555	<u>2</u>	MOUNT,SHOCK
112633	<u>3</u>	COVER,EXHAUST
116961	<u>4</u>	SEAL,COVER EXHAUST
108418	<u>5</u>	SPACER,COVER EXHAUST
MSC6100-30	<u>6</u>	SCREW,SHCS,M6X1.00X30
MPW6.3	<u>7</u>	WASHER,PWN M6
108559	<u>8</u>	CAP,MACHINING
108416	<u>9</u>	SEAL,FRAME
103859	<u>10</u>	NUT,HFN,M8X1.25
107236	<u>11</u>	BUMPER,PISTON STOP
107235	<u>12</u>	SPRING,COMPRESSION
112635	<u>13</u>	O-RING,1.988X.118
107234	<u>14</u>	HEAD VALVE
107658	<u>15</u>	O-RING,2.512X.118
851606	<u>16</u>	O-RING,1.850X.210
158582	<u>17</u>	ASSEMBLY,PISTON/DRIVER,RH
158547	<u>18</u>	PISTON,MAIN,RH FLANGED
158548	<u>19</u>	DRIVER,RH FLANGED
107142	<u>20</u>	RETAINER,CYLINDER SLEEVE
107141	<u>21</u>	SEAL,CYLINDER SLEEVE
144625	<u>22</u>	SLEEVE,CYLINDER
89673	<u>23</u>	O-RING,2.550X.103
107269	<u>24</u>	SEAL,CHECK
108563	<u>25</u>	RING,CYLINDER SLEEVE
108718	<u>26</u>	O-RING,3.484X.139
108560	<u>27</u>	SEAL,END CAP
108722	<u>28</u>	CAP,END
T50118	<u>29</u>	WASHER,PLAIN
MSC5080-20	<u>30</u>	SCREW,SOC HD. CAP M5 X 20
112733	<u>31</u>	PROTECTOR,FRAME
MHE3050-100	<u>32</u>	NUT,NYLON M3X.50
120879	<u>33</u>	LABEL,N88RH
144320	<u>34</u>	FRAME,OVERMOLD
107231	<u>35</u>	BUMPER,DRIVE
MSC4070-12	<u>36</u>	SCREW,SHCS,M4X0.70X12
112632	<u>37</u>	BUSHING,TRIP COVER
116969	<u>38</u>	COVER,TRIP
116966	<u>39</u>	ARM,UPPER CONTACT
115261	<u>40</u>	NOSE
116970	<u>41</u>	SPRING,CONTACT ARM
108224	<u>42</u>	CASTING,HOUSING CONTACT
121072	<u>43</u>	ASSEMBLY,TRIP FOOT
MSC8125-28	<u>44</u>	SCREW,SHCS M8X28
142941	<u>45</u>	ARM,LOWER CONTACT
108225	<u>46</u>	CASTING,PLUNGER
115230	<u>47</u>	SPRING,HOUSING
116964	<u>48</u>	LABEL,MAGNESIUM
112629	<u>49</u>	GUIDE,ARM
100387	<u>50</u>	SPRING,COMPRESSION
SEQ4	<u>51</u>	KIT,SEQUENTIAL TRIP CONVERSION

TVA11	<u>53</u>	KIT,TRIGGER VALVE
108562	<u>54</u>	SCREW,TRIGGER PIVOT
100298	<u>55</u>	PIN,SPIRAL M3X30
MPP030020	<u>56</u>	PIN,SPIRAL M3X20MM
MPW6.2	<u>57</u>	WASHER.SPECIAL
123859	<u>58</u>	BUSHING,FLANGED ISOLATION
MHE6100-100	<u>59</u>	NUT,ESN M6X1
123856	<u>60</u>	BRACKET,N88RH
158612	<u>61</u>	LABEL,WARNING
159722	<u>62</u>	LABEL,N88RH-2MCN FASTENER SPEC
121407	<u>63</u>	PIN,SPECIAL
MSB6100-12	<u>64</u>	SCREW,SBHCS,M6X1.00X12
116536	<u>65</u>	MAGAZINE
121472	<u>66</u>	SPACER,PUSHER LATCH
120875	<u>67</u>	LATCH,PUSHER
116563	<u>68</u>	CAP END,MAGAZINE
120878	<u>69</u>	SPRING, PUSHER LATCH
100261	<u>70</u>	SCREW,SHCS,M4X30
MPW4	<u>71</u>	WASHER,PWN,M4
MHE4070-100	<u>72</u>	ELASTIC STOP NUT,M4
121406	<u>73</u>	LINER,NAIL GUIDE
115143	<u>74</u>	SPRING,CONSTANT FORCE
120945	<u>75</u>	HANDLE,PUSHER
149745	<u>76</u>	PUSHER
100209	<u>77</u>	SCREW,STRHS,M3X0.5X12
89013	<u>78</u>	O-RING,.056X.060
121512	<u>79</u>	WASHER,SPECIAL
112630	<u>80</u>	SHIELD,DUST
112631	<u>81</u>	SPRING,CLIP
104981	<u>82</u>	LABEL,WARNING
121070	<u>83</u>	FOOT,TRIP
121071	<u>84</u>	CLIP,TRIP FOOT
MCN-KIT	<u>85</u>	MCN ATTACHMENT FOR N88RH-2
121043	<u>86</u>	GUIDE,MCN
124458	<u>87</u>	SPRING,MCN GUIDE
159641	<u>88</u>	PIN,SPRING,M2.5X14MM
159998	<u>89</u>	BODY,MCN
160016	<u>90</u>	PIN,MCN PENDULUM
158456	<u>91</u>	PENDULUM,MCN
158457	<u>92</u>	SPRING,MCN PENDULUM
854004	<u>93</u>	WASHER,RUBBER-7
159721	<u>94</u>	LABEL,WARNING,METAL CONNECTOR