

BOSTITCH®

RN46

COIL-FED PNEUMATIC ROOFING NAILER
CLAVADORA NEUMÁTICA ALIMENTADA POR ROLLO PARA TECHADO
CLOUEUR PNEUMATIQUE À ENROULEMENT POUR TOITURE



TOOL PARTS ILLUSTRATION
ILUSTRACIÓN DE LAS PIEZAS DE LA HERRAMIENTA
ILLUSTRATION DES PIÈCES D'OUTILLAGE

⚠WARNING:

⚠ATTENTION:

⚠ADVERTENCIA:

BEFORE PERFORMING REPAIRS ON THIS TOOL, ALL OPERATORS SHOULD STUDY THIS ILLUSTRATION, AS WELL AS THE PARTS LIST AND OPERATION AND MAINTENANCE MANUAL. OPERATORS SHOULD UNDERSTAND AND FOLLOW ALL SAFETY WARNINGS AND INSTRUCTIONS. KEEP THIS ILLUSTRATION WITH THE TOOL FOR FUTURE REFERENCE. IF YOU HAVE ANY QUESTIONS, CONTACT YOUR BOSTITCH REPRESENTATIVE OR DISTRIBUTOR.

ANTES DE LLEVAR A CABO CUALQUIER REPARACIÓN EN LA HERRAMIENTA, TODOS LOS OPERARIOS DEBERÁN ESTUDIAR ESTA ILUSTRACIÓN, ASÍ COMO LA LISTA DE PIEZAS Y EL MANUAL DE OPERACIÓN Y MANTENIMIENTO. LOS OPERARIOS DEBERÁN ENTENDER Y SEGUIR TODAS LAS ADVERTENCIAS E INSTRUCCIONES DE SEGURIDAD. CONSERVE ESTA ILUSTRACIÓN CON LA HERRAMIENTA PARA PODER CONSULTARLA EN LO FUTURO. SI TUVIERA ALGUNA PREGUNTA, PÓNGASE EN CONTACTO CON SU REPRESENTANTE O DISTRIBUIDOR DE BOSTITCH.

AVANT DE PROCÉDER À LA RÉPARATION DE CET OUTIL, LES OPÉRATEURS DOIVENT ÉTUDIER LA PRÉSENTE ILLUSTRATION AINSI QUE LA LISTE DE PIÈCES ET LE MANUEL D'INSTRUCTIONS ET D'ENTRETIEN ; ILS DOIVENT ÉGALEMENT COMPRENDRE ET OBSERVER LES CONSIGNES DE SÉCURITÉ ET LES INSTRUCTIONS. CONSERVER CETTE ILLUSTRATION AVEC L'OUTIL POUR RÉFÉRENCE FUTURE. SI VOUS AVEZ DES QUESTIONS, COMMUNIQUEZ AVEC VOTRE REPRÉSENTANT OU VOTRE DISTRIBUTEUR DE BOSTITCH.

RN46

COIL-FED PNEUMATIC ROOFING NAILER
CLAVADORA NEUMÁTICA ALIMENTADA POR ROLLO PARA TECHADO
CLOUEUR PNEUMATIQUE À ENROULEMENT POUR TOITURE

Item 62 available (Not Shown)
 Rebuild Kit RN46-RK
 Includes Items 4 thru 11, 13, 15, 18,
 34, 36, 38, 50, 61, & 63.

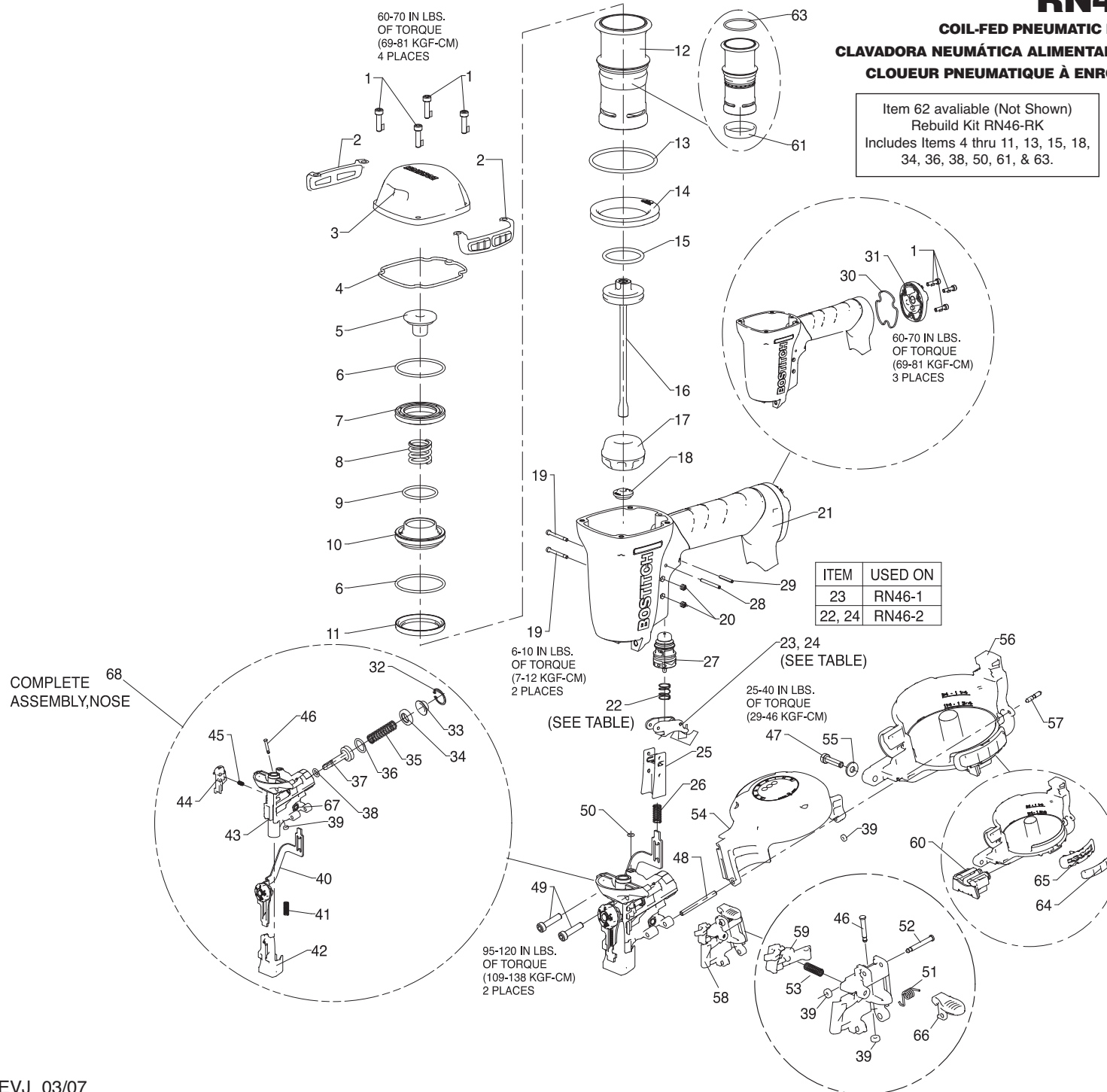

ITEM	USED ON
23	RN46-1
22, 24	RN46-2

Item#	Illus. #	Description
MSC5080-20	<u>1</u>	SCREW,SOC HD. CAP M5 X 20
149845	<u>2</u>	ASSEMBLY,WEAR PLATE
149808	<u>3</u>	CAP,MACHINING
149832	<u>4</u>	SEAL,FRAME/CAP
149838	<u>5</u>	BUMPER,HEAD VALVE
149828	<u>6</u>	O-RING,1.925X.103 XNBR
149836	<u>7</u>	UPPER BODY,HEAD VALVE
149806	<u>8</u>	SPRING,HEAD VALVE
149842	<u>9</u>	O-RING,1.299X.103 XNBR
149839	<u>10</u>	LOWER BODY,HEAD VALVE
149840	<u>11</u>	SEAL,SLEEVE
149941	<u>12</u>	ASSEMBLY,SLEEVE
850766	<u>13</u>	O-RING,2.609X.139
149814	<u>14</u>	RING,SLEEVE
850607	<u>15</u>	O-RING,1.484X.139
149826	<u>16</u>	ASSEMBLY,PISTON/DRIVER
149803	<u>17</u>	BUMPER
149820	<u>18</u>	GUIDE,DRIVER
105811	<u>19</u>	SCREW,TRIGGER PIVOT
MHE3050-100	<u>20</u>	NUT,NYLON M3X.50
149830	<u>21</u>	ASSEMBLY,FRAME
100387	<u>22</u>	SPRING,COMPRESSION
107581	<u>23</u>	ASSEMBLY,C.T.TRIGGER
107582	<u>24</u>	ASSEMBLY,S.T.TRIGGER
107522	<u>25</u>	GUIDE,TRIP
149871	<u>26</u>	SPRING,CONTACT ARM
TVA6	<u>27</u>	KIT,TRIGGER VALVE
100298	<u>28</u>	PIN, SPIRAL M3X30
MPP030020	<u>29</u>	PIN, SPIRAL M3X20MM
149816	<u>30</u>	SEAL,END CAP
149817	<u>31</u>	CAP,END
149854	<u>32</u>	RETAINING RING,INCH
149853	<u>33</u>	COLLAR,SPRING
149855	<u>34</u>	STOP,FEED PISTON
149887	<u>35</u>	SPRING,FEED PISTON
88998	<u>36</u>	O-RING,.674X.103
149852	<u>37</u>	FEED,PISTON
149883	<u>38</u>	O-RING,.299X.103 NBR
N12112	<u>39</u>	HINGE PIN RETAINER
149899	<u>40</u>	ASSEMBLY,TRIP
149874	<u>41</u>	SPRING,DEPTH ADJUST CAM
149900	<u>42</u>	ASSEMBLY,CONTACT ARM FOOT
160141	<u>43</u>	NOSE
149897	<u>44</u>	PAWL,FEED
149859	<u>45</u>	SPRING,FEED PAWL
149882	<u>46</u>	PIN,CHECK PAWL
MSC6100-25	<u>47</u>	SCREW,SHCS,M6X1.00X25
149905	<u>48</u>	PIN,DOOR/COVER
MSC6100-30	<u>49</u>	SCREW,SHCS,M6X1.00X30
149885	<u>50</u>	O-RING,.145X.070 CP
149831	<u>51</u>	SPRING,TORSION DOOR LATCH

149886	<u>52</u>	PIN, DOOR LATCH
149898	<u>53</u>	SPRING, CHECK PAWL
149943	<u>54</u>	ASSEMBLY, COVER/CANISTER
MPW6.2	<u>55</u>	WASHER, SPECIAL
149939	<u>56</u>	ASSEMBLY, CANISTER
149907	<u>57</u>	PIN, COVER/CANISTER
160144	<u>58</u>	ASSEMBLY, DOOR
160142	<u>59</u>	PAWL, CHECK
149940	<u>60</u>	ASSEMBLY, SHINGLE GUIDE
149812	<u>61</u>	SEAL, CHECK
RN46-RK	<u>62</u>	REBUILD KIT, RN46
149829	<u>63</u>	O-RING, 1.862X.103 NBR
149866	<u>64</u>	WEAR PAD, CANISTER
161236	<u>65</u>	GUARD, CANISTER
149861	<u>66</u>	LATCH
MHE6100-100	<u>67</u>	NUT, ESN M6X1