

# SDCN10B PNEUMATIC COIL NAILER

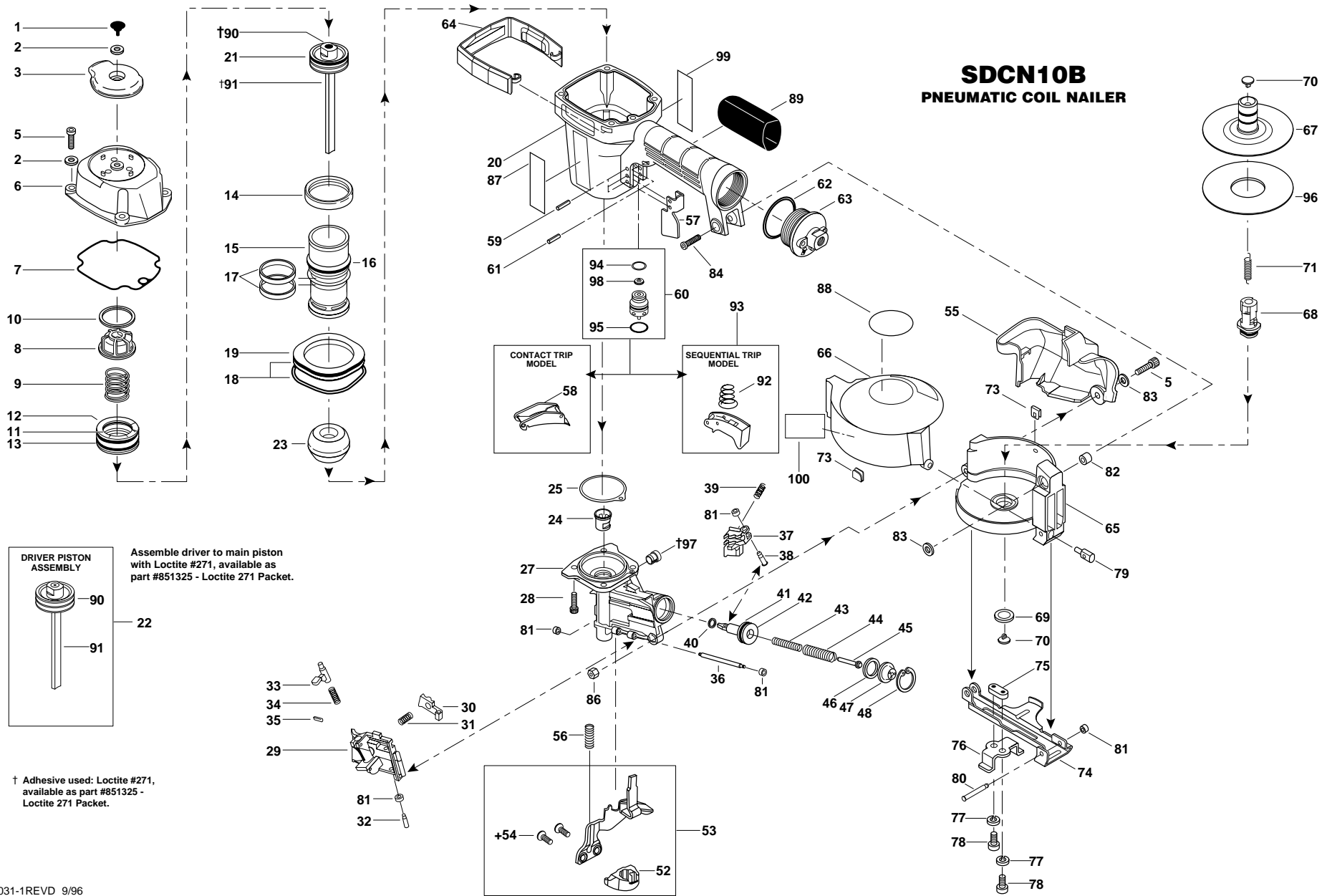

Assemble driver to main piston with Loctite #271, available as part #851325 - Loctite 271 Packet.

DRIVER PISTON ASSEMBLY

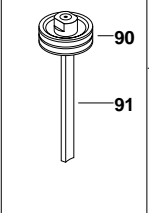

† Adhesive used: Loctite #271, available as part #851325 - Loctite 271 Packet.

TO SAVE FOR FUTURE REFERENCE:  
to file this illustration in a ring binder, cut on the line above and punch holes where indicated on the other end of this sheet

## Spare Parts for SDCN10B

Item#	Illus. #	Description
MSLC6100-16	1	SCREW, SLHCS M6 X 1.00X16
MPW6.3	2	WASHER,PWN M6
T55034	3	COVER, EXHAUST
MSC6100-30	5	SCREW,SHCS,M6X1.00X30
104205	6	CAP,FRAME
100212	7	GASKET,FRAME/CAP
T55050	8	BUMPER, PISTON STOP
854016	9	SPRING,HEAD VALVE
T55031	10	RING, BUMPER
MRG041630	11	O-RING,1.638X.118
102943	12	VALVE,HEAD
MRG052526	13	O-RING,2.067X.103
T60006	14	SEAL, CYLINDER
102026	15	SLEEVE,CYLINDER
850006	16	O-RING,1.987X.103
T60021	17	SEAL,CHECK
100309	18	O-RING,2.887X.139
100181	19	RING,CYLINDER SLEEVE
101174	20	FRAME (MACH. - BLUE)
850607	21	O-RING,1.484X.139
101961	22	PISTON/DRIVER ASSY
101200	23	BUMPER,LOWER
101857	24	GUIDE,DRIVER
102301	25	SEAL,NOSE
104522	27	ASSEMBLY,NOSE
MSC6100-22	28	SCREW,SHCS,M6X1X22
104738	29	DOOR
102150	30	PAWL,CHECK
854011	31	COMPRESSION SPRING

100313	32	9-N, CHECK PAWL
N70150	33	LATCH DOOR
101408	34	SPRING, COMPRESSION
MPG030012	35	PIN, ROLL 3 X 12
100314	36	PIN, DOOR
104087	37	FEED PAWL
100315	38	PIN, FEED PAWL
100316	39	SPRING, COMPRESSION
MRG009824	40	O-RING, .386X.094
100135	41	PISTON, FEED
851437	42	O-RING, .819X.095
N65042	43	COMP SPRING 3428
N65043	44	COMP SPRING 3335
N65044	45	SPRING GUIDE
N70162	46	STOP, FEED PISTON
N65045	47	COLLAR SPRING
MRB026	48	RETAINING RING, METRIC
100225	52	FOOT, CONTACT ARM
100225	52	FOOT, CONTACT ARM
102996	53	ASSEMBLY, TRIP ARM
100320	54	SCREW, SFHCS, M6X1.0X11
100320	54	SCREW, SFHCS, M6X1.0X11
100321	55	COVER, TRIP,
100874	56	TRIP SPRING
100323	57	GUIDE, ARM
N50082A	58	ASSEMBLY, TRIGGER
MPP030025	59	PIN, SPIROL, M3X25
TVA1	60	KIT, TRIGGER VALVE
102549	61	PIN, SPECIAL SPIRAL
850235	62	O-RING, 1.487X.103
N60102	63	HANDLE END

100219	64	PROTECTOR,FRAME
100213	65	CANISTER
100214	66	COVER, CANISTER
100308	67	PLATFORM,CANISTER
100105	68	POST,CANISTER
N12113	69	RETAINER, POST
100324	70	RECEIVER, SPRING
101773	71	SPRING
100326	73	WEAR CLIP, CANISTER
100215	74	BRACKET,GAUGE
100327	75	NUT PLATE,GAUGE
100216	76	GAUGE
MLW6	77	WASHER,HSLW M6
MSC6100-12	78	SCREW,SHCS,M6X1.00X12
100217	79	PIVOT,CANISTER COVER
100328	80	PIN, GAGE BRACKET
N12112	81	PIN, RETAINER
100329	82	BUSHING, CANISTER
MPW6.2	83	WASHER.SPECIAL
MSC6100-25	84	SCREW,SHCS,M6X1.00X25
MHE6100-100	86	NUT,ESN M6X1
101170	87	LABEL, STAN-TECH 7/8
100269	88	LABEL,WARNING
100198	89	GRIP,FRAME HANDLE RN45
100211	90	PISTON,DRIVE
101962	91	DRIVER,REPLACEMENT
100387	92	SPRING, COMPRESSION
SEQ1	93	KIT,SEQUENTIAL TRIP CONV.
86459	94	O-RING,.614X.070
851554	95	O-RING,.703X.103
100475	96	DAMPER, PLATFORM

101584 97 MAGNET BUSHING ASSEMBLY

N86118 98 CAP,ORIFICE GRAY

103648 100 LABEL,PLATFORM ADJUST