

# PASLODE<sup>®</sup>

## OPERATION, PARTS & SAFETY MANUAL

### MAGNUM<sup>®</sup>

## EXTRA-WIDE CROWN STAPLER

## MODEL MA-WW12

A portable, lightweight,  
pneumatic tool to drive  
1-9/16" -wide crown 12 ga.  
staples



Manufactured under one or more of the following U.S. Pat. Nos.

3,032,184	3,094,901	3,269,274	3,357,761	3,774,293
3,068,485	3,106,136	3,272,267	3,401,072	3,774,833
3,081,740	3,133,288	3,272,417	3,410,620	3,815,475
3,081,741	3,152,334	3,276,576	3,468,590	3,822,819
3,081,742	3,194,324	3,285,489	3,628,714	3,840,165
3,082,425	3,207,405	3,323,183	3,653,117	3,841,473
3,084,672	3,218,700	3,329,068	3,653,299	3,851,371
3,086,207	3,229,589	3,552,274	3,717,891	3,851,759
3,094,900	3,261,527	3,353,737	3,722,670	3,878,663
				3,966,042

***Paslode***<sup>®</sup>  
**corporation**

# **OPERATOR SAFETY INSTRUCTIONS**

While Paslode has designed, produced and inspected all its tools with safety in mind, there are certain basic safety precautions that should always be taken by the operator. These include:

1. NEVER operate or work in the vicinity of a tool in use without hearing protection and eye protection devices, including side shields.
2. NEVER assume the tool is empty. Check the magazine.
3. NEVER engage in horseplay with the tool; it is not a toy.
4. NEVER point the tool at anyone or yourself, even if you think it is empty or disconnected.
5. NEVER operate the tool unless it is in contact with the workpiece.
6. NEVER tamper with, disable, or remove the safety device.
7. NEVER leave the work area for any extended period of time WITHOUT DISCONNECTING the tool from the air line.
8. NEVER attempt to clear a jam without disconnecting the tool from the air line and removing the remaining fasteners from the tool.
9. NEVER allow the air pressure to exceed the maximum marked on the tool. Check the air pressure gauge at least twice daily. Do not operate with bottled air or gases.
10. NEVER operate a dirty tool. Clean the tool at least daily and lubricate if required.
11. In case of tool malfunction:
  - (a) Disconnect from air line immediately and remove all fasteners from magazine.
  - (b) Turn the tool over immediately to the person responsible for repair, or attach a tag to the air inlet indicating the tool should not be used.
  - (c) NEVER re-connect to the air line until the tool is thoroughly repaired and inspected.
12. NEVER carry the tool with the trigger depressed.
13. NEVER clamp the trigger in a locked operating position.
14. NEVER load the tool with either the trigger or safety depressed.
15. NEVER use parts or fasteners other than those specifically designed and recommended by Paslode for use in the tool and the work to be done.
16. NEVER attempt to modify the tool in any way.
17. For detailed information on the tool installation, maintenance and loading instructions, refer to the last page of this manual.
18. Treat the tool with respect and it will perform safely and reliably for you.

**TOOLS DO NOT CAUSE ACCIDENTS — PEOPLE DO!**

**Safety Instructions in Spanish are available from your sales representative.**

**Su vendedor le puede proporcionar los instructivos de seguridad en español.**

# PASLODE® MAGNUM EXTRA-W

**1\* HANGER ASSEMBLY  
with cap screws  
NO. 091988**

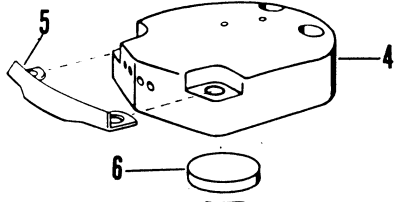
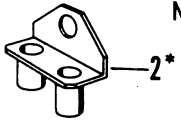

**DIAPHRAGM ASSEMBLY  
NO. 091977**

**PISTON ASSEMBLY  
NO. 091691**

(Coded Yellow)

**VALVE ASSEMBLY  
NO. 091842**

**WARNING**  
STUDY HEAVY DUTY TOOL SAFETY INSTRUCTIONS BEFORE USING.  
SAFETY GLASSES AND HEARING PROTECTION SHOULD BE WORN AT ALL TIMES. DO NOT OPERATE THE TOOL IN THE VICINITY OF CHILDREN OR OTHER PERSONS.  
USE FILTERS, REGULATORS, LUBRICANTS AS ONLY SPECIFIED BY THE TOOL MANUFACTURER.  
DO NOT EXCEED O.P.S.

# MA-WIDE CROWN STAPLER MODEL MA-WW12

## PARTS LIST

KEY NO.	PART NAME	QUAN	PART NO.	KEY NO.	PART NAME	QUAN.	PART NO.
1*	Soc. Hd. Cap Scr. 1/4-20 x 1-1/2	2	091362	35	Body, Valve	1	091517
2*	Hanger Assembly	1	091566	36	Spring, Valve Button	1	091523
3	Soc. Hd. Cap Scr. 1-1/4-20 x 1	6	091592	37	Button, Valve	1	091816
4	Cap	1	091502	38	Spirolox Retaining Ring	1	091555
5	Deflector	1	091912	39	Sleeve	1	091509
6	Bumper, Cap	1	091503	40	"O" Ring	1	091208
7	"O" Ring	1	091540	41	Cylinder	1	091676
8	Piston Cap	1	091504	42	Reducing Pipe Bushing	1	091622
9	"O" Ring	1	091542	43	Roll Pin 5/32 x 1-1/8	1	091550
10	"O" Ring	1	092709	44	Lever, Safety Trigger	1	091817
11	Seal Cap	1	091505	45	Pin, Trigger	1	091821
12	Spring, Diaphragm	1	090495	46	Trigger, Safety	1	091818
13	Plate, Diaphragm	1	091506	47	Flexloc Thin Nut 8-32	3	091363
14	"O" Ring	1	091623	48	Roll Pin 3/32 x 5/8	1	091880
16	Diaphragm	1	094736	49	Back Plate	1	091681
17	Washer, Diaphragm	1	091508	50	Guide	1	091682
18	Flexloc Thin Nut 3/8-24	1	091544	51	Roll Pin 3/32 x 1/2	1	091551
19	"O" Ring (Coded Yellow)	1	091538	52	Pin, Safety	1	091573
20	Piston	1	091510	53	Spring, Safety	1	091574
21	Rubber Ball	2	091543	54	Bracket, Safety	1	091975
22	Drive Lok Pin	1	091552	55	Washer, Safety	1	091572
23	"O" Ring	1	091539	56	Guide, Safety	1	091976
24	Bumper, Piston	1	091511	57	Drum, Negator	1	091534
25	Blade, Driver	1	091684	58	Negator Assembly	1	091663
26	"O" Ring	1	091591	59	Reinforcement Strap	1	091993
27	Spacer	1	091686	60	Button Hd. Soc. Cap Scr. 1/4-20 x 1/2	6	091547
28	"O" Ring	1	091624	61	Rail Assembly	1	091677
29	Insert, Valve	1	091519	62	Rail Cover	1	091685
30	"O" Ring	1	095419	63	Rd. Hd. Mach. Screw 8-32 x 3/8	2	092739
31	Pin, Valve	1	091518	64	Spring	1	007741
31A	Spring Seat Retainer	1	096110	65	Latch, Follower	1	091688
32	Seat, Valve	1	091520	66	Roll Pin 3/32 x 3/8	1	004998
33	Roll Pin 1/16 x 5/8	1	095420	67	Follower	1	091687
34	"O" Ring	2	091541	68	Warning Label	1	096120

### \*Optional Parts

When ordering parts please show tool model, part number and name.

Standard hardware items listed above are available at any local hardware supply.

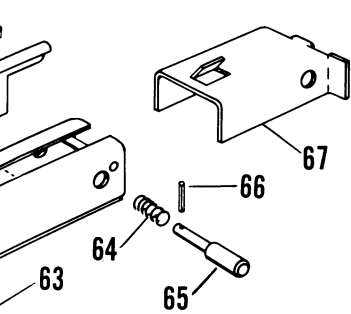

MA-WW12 (Part No. 091291)

# TROUBLE SHOOTING CHART

SYMPTOM	POSSIBLE CAUSE	REMEDY
1. PISTON-BLADE ASSEMBLY STAYS DOWN WHEN HOOKED TO AIR	1a Blade (Key #25) out of proper alignment in relation to guide (Key #50) (binding)	1a Realign guide Replace piston assembly (#091691)
	1b Burred or bent driver blade (Key #25)	1b Replace blade
	1c Diaphragm assembly (#091977) stuck in "up" position check "O" ring binding (Key #7, 9 & 10)	1c Determine which "O" ring is binding and replace (grease assembly)
	1d Piston (Key #10) "O" rings (Key #11 & 12) reversed	1c Reverse "O" rings position. Larger "O" ring coded yellow belongs on top
2. FASTENER MISFIRE (SKIPS)	2a Feed mechanism dragging - follower (Key #67) - negator (Key #58)	2a Locate bind - correct
	2b Negator (Key #58) weak	2b Replace negator
	2c Piston assembly (#091691) does not return fast enough	2c Piston "O" rings (Key #19 & 23) dry, replace or grease
3. PISTON WILL NOT CYCLE FAST ENOUGH	3a Blade (Key #25) out of proper alignment in relation to guide (Key #50) (binding)	3a Realign guide Replace piston assembly (#091691)
	3b Piston "O" rings (Key #19 & 23) dry and worn	3b Replace piston "O" rings (grease)
4. AIR LEAKING REAR OF VALVE PORT WHEN HOOKED UP	4a Valve seat (Key #32) not sealing	4a Replace valve assembly (#091842) Replace seat
	4b "O" ring (Key #34) cut	4b Replace "O" ring
5. ERRATIC DRIVE CHARACTERISTICS	5a Diaphragm assembly (#091977) nut (Key #18) loose	5a Tighten nut
	5b Safety bracket (Key #54) bent	5b Replace safety bracket
6. AIR HOOKUP, TRIGGERED - NO ACTION AT ALL	6a Upper valve "O" ring (Key #34) cut or broken	6a Replace "O" ring
7. FASTENER WILL NOT DRIVE DOWN TIGHT	7a Driver Blade (Key #25) rounded off and slipping off staple crown	7a Replace blade
	7b Too low air pressure	7b Increase to adequate air pressure
8. AIR LEAKING BOTTOM CASTING HOLES	8a Sleeve "O" ring (Key #40) cut or broken	8a Replace "O" ring
	8b Worn or broken lower piston "O" ring (Key #23)	8b Replace "O" ring
9. AIR LEAKING TOP CAP ASSEMBLY 1/16" VENT HOLE (OFF CENTER)	9a "O" ring (Key #9) cut or broken	9a Remove and replace
	9b "O" ring (Key #14) cut or broken	9b Remove and replace
10. STAPLES JAMMING IN NOSE OF TOOL	10a Guide (Key #50) loose	10a Tighten hold down screws (Key #3)
	10b Check blade tip (Key #25)	10b Replace blade
11. BLADE DRIVING TOO DEEPLY	11a Worn bumper (Key #24) and/or overdrive	11a Replace bumper or shim up assembly
	11b Excessive air pressure in light wood	11b Reduce air pressure
12. TOOL FIRES WHEN HOOKED UP TO AIR	12a Missing diaphragm spring (Key #12)	12a Install spring

## INSTALLATION

The Magnum Extra-Wide Crown Stapler has been designed for a **maximum safe operating pressure of 120 p.s.i.** Always use the minimum air pressure necessary to do the job properly.

A filter, pressure regulator and lubricator unit with gauge should be installed as close as possible to the tool. Every tool must be equipped with a male quick disconnect nipple installed at the air inlet of the tool. The nipple should be a pneumatic type which discharges the air from the tool when it is disconnected. Air lines should be a minimum of 5/16" in diameter and should be kept as short as possible. Air lines

ahead of the regulator should be a minimum of 3/4".

In general, no special installation is required. If the operator is working at a bench or table, it is usually easiest to feed the air line from underneath the bench. A small tray can be fastened under the bench top to hold the tool when not in use. This same tray can also hold the staple supply.

**If this tool malfunctions upon installation, do not attempt to disassemble and make repairs. Please call your Paslode representative immediately at 800-323-1303 (toll-free).**

## MAINTENANCE

The Magnum Extra-Wide Crown Stapler has been designed with ease of maintenance in mind. A few simple maintenance details will assure trouble free operation and long tool life. Any person repairing the

tool must study the Operator Safety Instructions, all maintenance instructions, and be familiar with the general parts arrangement (depicted elsewhere in this manual), prior to beginning repairs.

1. Keep lubricator filled with Paslode Pneumatic Tool Lubricating Oil (Part #096291). Make certain that lubricator is operating in accordance with the manufacturers recommendations.
2. Keep magazine rail and follower clean. General practice is to blow it clean daily.
3. If for any reason it is necessary to remove any moving parts, it should be lubricated with Lubri-plate "Aero" grease #093593 or equivalent.
4. Tool repair, if needed, should only be made with Paslode authorized parts.

## LOADING

One of the finest features of Paslode Magnum Extra-Wide Crown Staplers is the ease with which they may be loaded. To load simply pull the follower back to the latch position. Insert one or two strips of staples over the rail and push down until the staple crown is under the rail cover.

Release the follower by depressing the small button which projects through its side. Do not allow the follower to slam into the staple strip.

## SAFETY

All tool operators and their immediate foremen must become familiar with the Operator Safety Instructions for Paslode Heavy Duty Staplers and Nailers prior to operating the tool. These instructions are contained elsewhere in this manual.

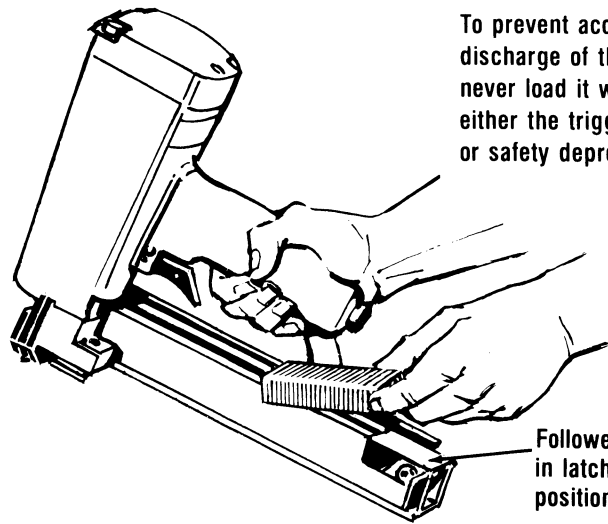

To prevent accidental discharge of the tool, never load it with either the trigger or safety depressed.

Follower in latch position

 **paslode**<sup>®</sup>  
**corporation**

A SIGNODE\* COMPANY  
TWO MARRIOTT DRIVE, LINCOLNSHIRE, ILLINOIS 60015