

BMK SERIES

Bossar Modular-Kit technology

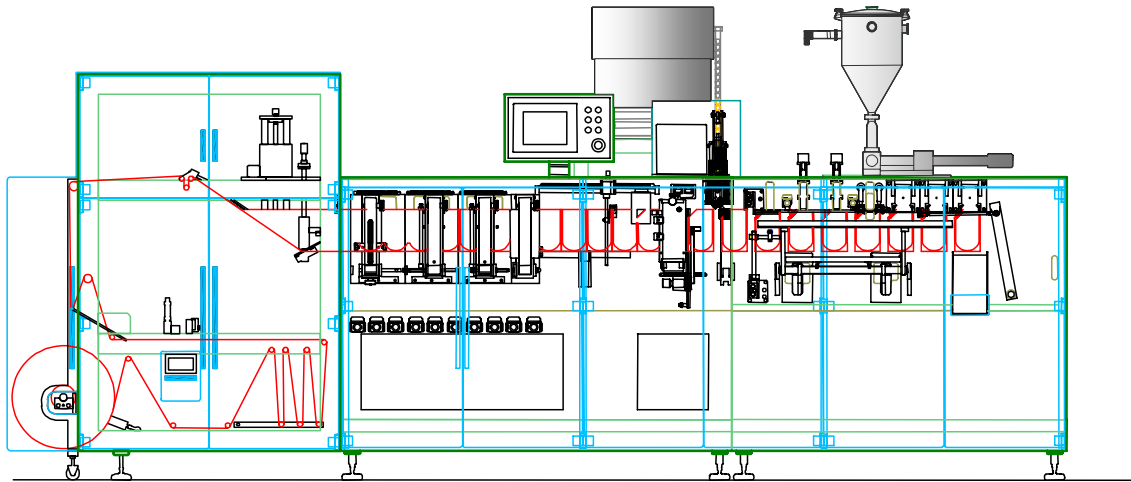

*Form Fill and Seal machine Model BMK-1400 up to 750 ml filling capacity.
Compact design of 5250 mm footprint.*

TRUE MODULAR MACHINES

BMK-1400 and BMK-2000

More features for a smart investment

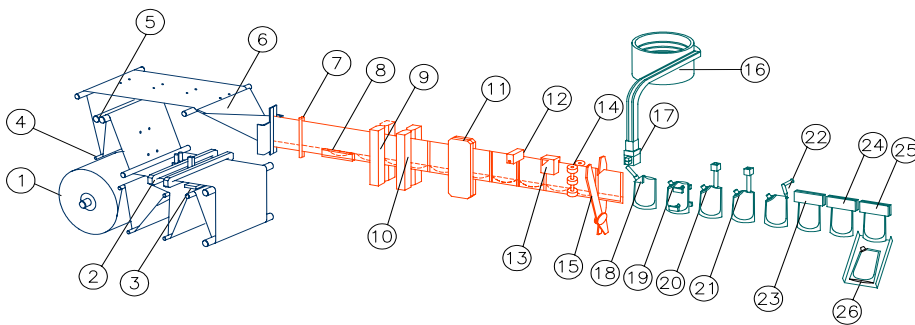

1. Printed reel of Ø máx. 500 mm.
2. Hole punching unit with photo-eye & space for printer.
3. Reel splicing table and end of reel detection.
4. Film pulling control tensioner.
5. Motorised unwind rollers.
6. Forming plough/gusset former.
7. Film guides.
8. Bottom seal group
9. 1st vertical sealing group

10. 2nd vertical sealing group
11. Cooling for bottom and vertical seals
12. Photo-eye for printing registration
13. Cutting die for corner
14. Servo film pulling unit
15. Pouch cutting group
16. Bowl for screw caps feeding
17. Guides for screw caps
18. Mechanical gripper arm for screw caps

19. Pouch opening
20. 1st filling station
21. 2nd filling station
22. Independent pouch stretching
23. 1st top sealing group
24. 2nd top sealing group
25. Top cooling group
26. Pouch exit



BOSSAR
HORIZONTAL POUCH MACHINERY

www.bossar.com

BMK-1400 and BMK-2000

The model BMK-1400 covers the range of small flat sachets traditionally for small doses. But as a new improvement, Bossar has incorporated the tooling required to make stand-up pouches as well. Moreover, the machine includes features typically used in larger, more expensive machines, such as : valve applicator (top, corner or front module), and zipper to run in Simplex mode.

The model BMK-1400 is a compact machine of 5 meters length ideal for smaller footprint requirements and lower capital cost. Yet, offers the features of bigger and more expensive machines.

The second machine model of the BMK series is the BMK-2000 that is traditionally oriented to wet applications like : liquids, creams and sauces of any kind. These applications are the ones that directly benefit from the modular design. Either of the three modules of the machine are available in stainless steel frame. Designed to accept specific configurations, either for liquids or solids.

BMK-1400					
Pouch type	Executior	Presentation	Format size (mm)		Speed up to (sachets/min)
			Minimum	Maximum	
Flat	S	3 – 4 sold	60 x 60	140 x 230	100
	D	3 – 4 sold	30 x 60	70 x 230	200
	SHP	Contour shape	30 x 60	100 x 190	60
STU	S	Gusset Doy-pack® Delta	60 x 70	140 x 230	70

BOSSAR launches a new concept of modular machines the Bossar Modular-Kit technology that satisfies :

Marketing, Production and Finance

**Suits to any budget.
Flexibility for potential growth and
adaptable to new packaging applications**

- √ Machine available in 1, 2 and 3 module combinations.
 - √ Newly designed higher speed walking beam.
- √ Flexibility to make different packaging styles thanks to newly redesigned groups.

BMK-2000					
Pouch style	Execution	Presentation	Format range (mm)		Speed up to (cycles/minute)
			Minimum	Maximum	
Flat	S	3 – 4 seals	100 x 100	200 x 270	90
	D	3 – 4 seals	60 x 80	100 x 120	180
STU	S	Gusset Doy-pack® Delta	100 x 100	200 x 270	70
	D	Gusset Doy-pack® Delta	60 x 80	100 x 270	140
FB	S	3 – 4 seals	100 x 100	200 x 270	90
		Doy-pack®			60
	D	3 – 4 seals	60 x 80	100 x 270	180
		Doy-pack®			120
PMP	S	3 – 4 seals	100 x 120	200 x 270	60*
		Doy-pack®			60
	D	3 – 4 seals	60 x 80	100 x 270	120
		Doy-pack®			120